

RECOMMENDED
CABLE STRIPPING DIM'S

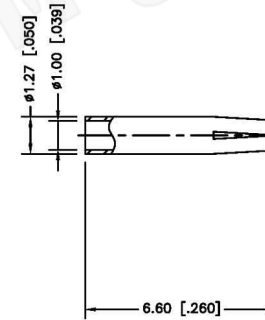
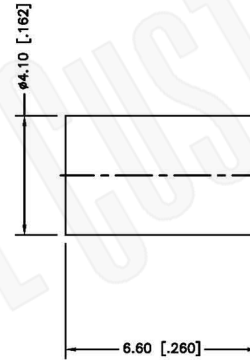
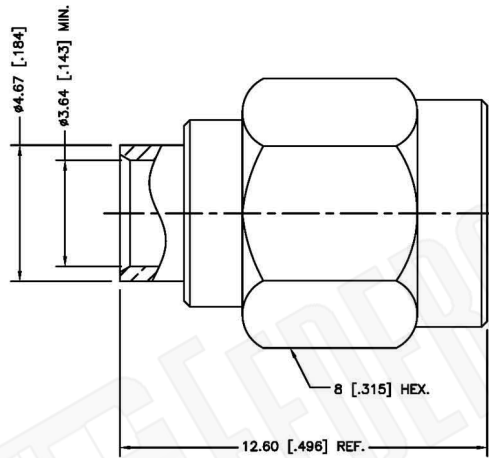

1. FREQUENCY RANGE: DC 0-18 GHz
2. VSWR(RETURN LOSS): 1.3, MAX.
3. DIELECTRIC WITHSTANDING VOLTAGE: 750 VRMS, MIN.
4. CONTACT PIN TO SOLDER

Material Specifications

Cable(s): .141 SEMI-RIGID, 402/U
 Body: Brass
 Finish: Gold
 Insulation: Teflon
 Impedence: 50 Ohms



Federal Custom Cable
www.FCCable.com

CAGE CODE
1UKX3

Part Number:

Description:

C3620RP

**SMA REVERSE POLARITY MALE CONNECTOR
 SOLDER FOR RG402, RG402AL, RG402FL CABLES**

1891 Alton Parkway, Irvine, CA 92606
 Phone: (949) 851-3114 | Fax: (949) 852-8136
Sales@FCCable.com

Dimensions
 Millimeters | Inches

Scale: N/A

Revision:

NOTES:
 1. DIMENSIONS ARE IN MILLIMETERS | INCHES
 2. UNLESS OTHERWISE SPECIFIED ALL DIMENSIONS ARE NOMINAL
 3. SPECIFICATIONS ARE SUBJECT TO CHANGE WITHOUT NOTICE

THIS DRAWING CONTAINS PROPRIETARY INFORMATION THAT BELONGS TO FEDERAL CUSTOM CABLE, LLC. ANY UNAUTHORIZED USE OF THIS DRAWING IS PROHIBITED WITHOUT WRITTEN PERMISSION FROM FEDERAL CUSTOM CABLE. ALL RIGHTS RESERVED. ©2016 COPYRIGHT FEDERAL CUSTOM CABLE, LLC.