

Material Specifications

Left Connector: C1013
 Right Connector: C1001
 Cable: RG174

NOTES:

1. XX EQUALS LENGTH IN INCHES
2. LF DESIGNATES LEAD FREE SOLDER

FCC Federal Custom Cable
 www.FCCable.com
 1891 Alton Parkway, Irvine, CA 92606
 Phone: (949) 851-3114 | Fax: (949) 852-8136
 Sales@FCCable.com

CAGE CODE 1UKX3	Part Number: CA1023LF-XX	Description: BNC MALE TO BNC FEMALE COAX CABLE ASSEMBLY WITH RG174 FLEXIBLE CABLE ROHS LEAD FREE
Scale: N/A	NOTES: 1. DIMENSIONS ARE IN MILLIMETERS INCHES 2. UNLESS OTHERWISE SPECIFIED ALL DIMENSIONS ARE NOMINAL 3. SPECIFICATIONS ARE SUBJECT TO CHANGE WITHOUT NOTICE	THIS DRAWING CONTAINS PROPRIETARY INFORMATION THAT BELONGS TO FEDERAL CUSTOM CABLE, LLC. ANY UNAUTHORIZED USE OF THIS DRAWING IS PROHIBITED WITHOUT WRITTEN PERMISSION FROM FEDERAL CUSTOM CABLE. ALL RIGHTS RESERVED. ©2016 COPYRIGHT FEDERAL CUSTOM CABLE, LLC.
Revision:		

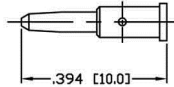
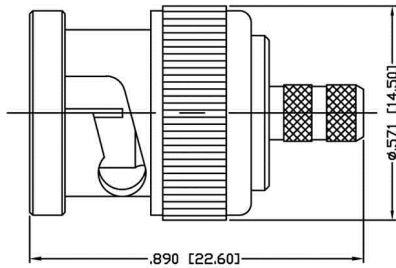

RECOMMENDED CRIMP DIE: .068"

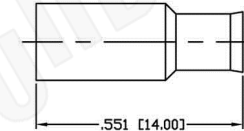
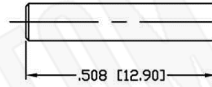

RECOMMENDED CRIMP DIE: .130" & .178"

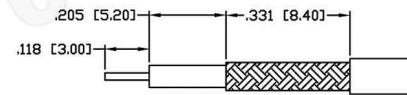

RECOMMENDED STRIPPING DIMENSIONS

Material Specifications

Cable(s): RG174-RG188-RG316
 Body: Brass
 Finish: Nickel
 Insulation: Teflon
 Impedence: 50 Ohms



Federal Custom Cable
www.FCCable.com

CAGE CODE
1UKX3

Part Number:

Description:

C1013

BNC MALE CONNECTOR CRIMP FOR RG174, RG188, RG316, B7805A CABLES

1891 Alton Parkway, Irvine, CA 92606
 Phone: (949) 851-3114 | Fax: (949) 852-8136
Sales@FCCable.com

Dimensions
Millimeters | Inches

Scale: N/A

Revision:

NOTES:
 1. DIMENSIONS ARE IN MILLIMETERS | INCHES
 2. UNLESS OTHERWISE SPECIFIED ALL DIMENSIONS ARE NOMINAL
 3. SPECIFICATIONS ARE SUBJECT TO CHANGE WITHOUT NOTICE

THIS DRAWING CONTAINS PROPRIETARY INFORMATION THAT BELONGS TO FEDERAL CUSTOM CABLE, LLC. ANY UNAUTHORIZED USE OF THIS DRAWING IS PROHIBITED WITHOUT WRITTEN PERMISSION FROM FEDERAL CUSTOM CABLE. ALL RIGHTS RESERVED. ©2016 COPYRIGHT FEDERAL CUSTOM CABLE, LLC.

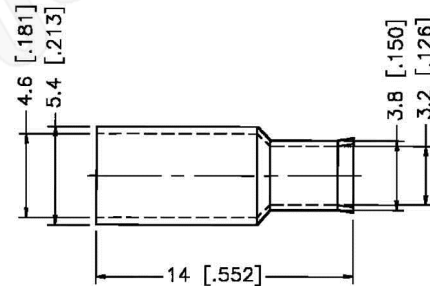
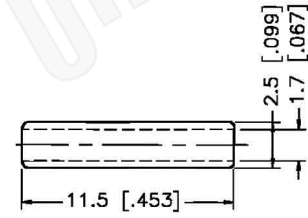
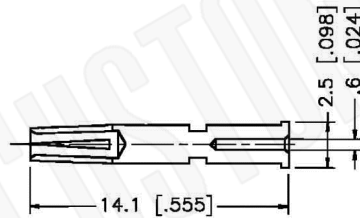
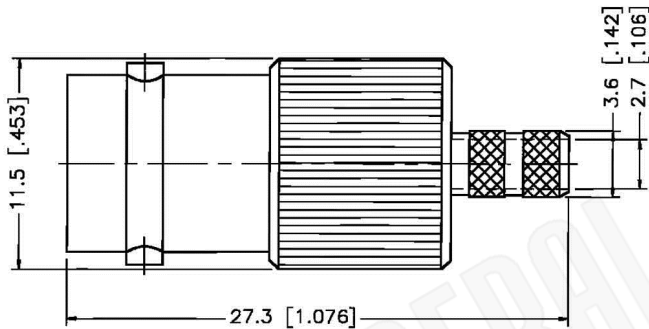
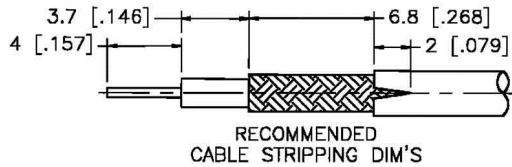

Material Specifications

Cable(s):	RG316, U-DOUBLE BRAIDED
Body:	Brass
Finish:	Nickel
Insulation:	Teflon
Impedence:	50 Ohms



Federal Custom Cable
www.FCCable.com

CAGE CODE
1UKX3

Part Number:

Description:

C1001

**BNC FEMALE CONNECTOR CRIMP FOR RG174,
RG188, RG316, B7805A CABLES**

1891 Alton Parkway, Irvine, CA 92606
Phone: (949) 851-3114 | Fax: (949) 852-8136
Sales@FCCable.com

Dimensions
Millimeters | Inches

Scale: N/A

Revision:

NOTES:
1. DIMENSIONS ARE IN MILLIMETERS | INCHES
2. UNLESS OTHERWISE SPECIFIED ALL DIMENSIONS ARE NOMINAL
3. SPECIFICATIONS ARE SUBJECT TO CHANGE WITHOUT NOTICE

THIS DRAWING CONTAINS PROPRIETARY INFORMATION THAT BELONGS TO FEDERAL CUSTOM CABLE, LLC. ANY UNAUTHORIZED USE OF THIS DRAWING IS PROHIBITED WITHOUT WRITTEN PERMISSION FROM FEDERAL CUSTOM CABLE. ALL RIGHTS RESERVED. ©2016 COPYRIGHT FEDERAL CUSTOM CABLE, LLC.

RG174A/U

50-Ohm Flexible Coax Cable; 0.100" Diameter, Single Shield, Black PVC Jacket

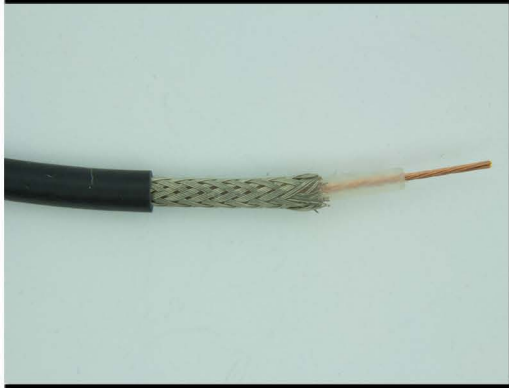

PART NUMBER:	RG174A/U
CATAGORY:	SEMI-RIGID
DESCRIPTION:	CABLE
IMPEDANCE:	50 OHMS
DIELECTRIC:	POLYETHYLENE
INSULATION DIAMETER:	0.060"
OVERALL DIAMETER:	0.110"

CONDUCTOR:

AWG:	26
STRANDING:	7X34
DIAMETER:	0.0191 IN.
MATERIAL:	BCCS (BARE COPPER COVERED STEEL)

PHYSICAL & MECHANICAL CHARACTERISTICS:

OUTER SHIELD TYPE:	BRAID
OUTER SHIELD MATERIAL:	TC (TINNED COPPER)
OUTER JACKET MATERIAL:	PVC (POLYVINYL CHLORIDE)
OPERATING TEMPERATURE RANGE:	-40 TO +75 DEGREES C
CABLE WEIGHT:	8.4 LBS/1000FT
MAXIMUM PULLING TENSION:	21 LBS.
MINIMUM BEND RADIUS (INSTALL):	1.0 IN.

ELECTRICAL CHARACTERISTICS:

INDUCTANCE:	0.077 MICROHENRY/FT
CAPACITANCE:	30.8 pF/FT
VELOCITY OF PROPAGATION:	66%
DELAY:	1.54 NS/FT
CONDUCTOR DC RESISTANCE:	97 OHMS/1000FT @20 DEGREES C
OUTER SHIELD DC RESISTANCE:	10.7 OHMS/1000FT @ 20 DEGREES C
MAXIMUM OPERATING VOLTAGE:	1100 VRMS (MILITARY)

NOMINAL ATTENUATION:	(dB/100FT)
A. 1 MHz:	1.9
B. 100 MHz:	8.4
C. 400 MHz:	19.0
D. 700 MHz:	27.0
E. 900 MHz:	31.0
F. 1.0 GHz:	34.0

FEDERAL CUSTOM CABLE

www.FCCABLE.com

ELECTRICAL CHARACTERISTICS CONTINUED:

MAXIMUM POWER:	(WATTS)
A. 1 MHz:	976
B. 100 MHz:	161
C. 400 MHz:	120
D. 700 MHz:	112
E. 900 MHz:	109
F. 1.0 GHz:	108

1891 Alton Prkwy | Irvine, California 92606

Local Call: (949) 851-3114 | Toll Free: (888) 440-8688 | Local Fax: (949) 852-8136 | Toll Free Fax: (800)874-2444